

SPECTRUM DEVELOPMENTS LIMITED

Rosemount House, Northern Cross, Malahide Road,
Dublin D17 NP20.

Telephone: 01 8673864

Planning Department
Dublin City Council,
Civic Offices,
Wood Quay,
Dublin 8.

Date: 9th December 2021

Dear Sir / Madam,

**RE: PLANNING APPLICATION FOR A PROPOSED RESIDENTIAL DEVELOPMENT AT
ROSEMOUNT HOUSE, NORTHERN CROSS, MALAHIDE ROAD, DUBLIN 17 NP20**

We, Spectrum Developments Limited, consent to the lands (pavement/roadways) within our ownership, the extent of such as captured within the two highlighted blue boxes on the attached Site Layout Plan, but not included in the red line, to be redeveloped in line with the detail on the attached Site Layout Plan.

Yours faithfully,

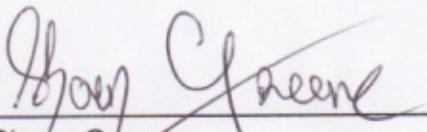
Shaun Greene
For and on behalf of
Spectrum Developments Limited

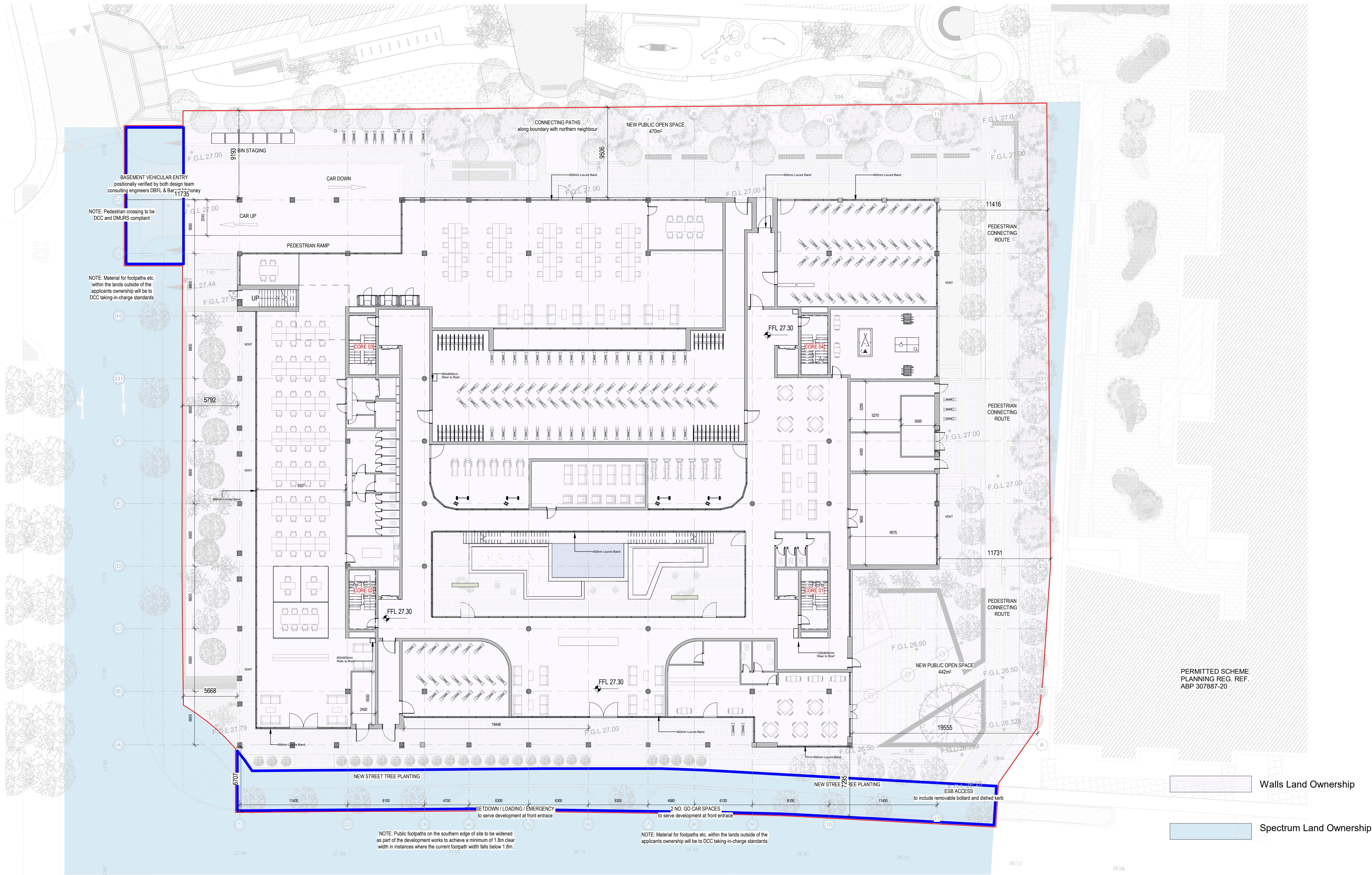

1 Spectrum LOC Plan
1:200

NOTES: Copyright of this drawing is vested in the Architect and it must not be copied or reproduced without consent. Planned dimensions only are to be taken from this drawing. All contractors must check site and be responsible for taking and checking all dimensions relative to their work. Plus Architecture are to be advised of any variation between drawings and site conditions. DO NOT SCALE OFF THIS DRAWING - IT IS SUBJECT AREA	REV.	DATE:	DETAILS:	INITIALS:	<div><div></div> Subject Application Boundary</div> <div><div></div> Spectrum LOC</div>	NORTH POINT: 	KEY PLAN: 	<div><div>++</div><div>PLUSARCHITECTURE</div><div>Exchequer Chambers, Exchequer Street, Dublin 2, Ireland. W: www.plusarchitecture.ie T: 353 (0) 1 521 3378</div></div>			
	PROJECT:	487	PROJECT:	487				PROJECT:	487	DATE:	12/07/21
	CLIENT:	Walls Construction Ltd	DRAWING NO.:	487_01_07				DRAWING NO.:	487_01_07	REVISION NO.:	
	TITLE:	Spectrum Letter of Consent Drawing	DRAWN BY:	LJ				DRAWN BY:	LJ	SCALE AT A1:	1:200
	ISSUE TYPE:	Planning	CHECKED BY:	DT				CHECKED BY:	DT	SCALE AT A3:	